

Furniture - Room Key

- Tenanted Offices
- Council Offices
- Cafeteria

Desks Schedule Opt1b

LEVEL 0 - Ground
161
LEVEL 1 - First
69
230 (Total)

Tenanted Areas Proposed Opt1b

Department	Area
LEVEL 0 - Ground	
New Tenanted	602.1 m²
	602.1 m²
LEVEL 1 - First	
New Tenanted	139.8 m²
	139.8 m²
	741.9 m²

P01	First Issue	03.02.22	GE	SO
Rev	Description	Date	Dr by	App by
original by	date created	approved by		
GE	01/10/22	SO		

AHR

AHR Architects Ltd
Vintry Building
Wine Street
Bristol
BS1 2BD
United Kingdom

T +44(0)117 9299146
E bristol@ahr.co.uk
www.ahr.co.uk

client name	Cotswold District Council
project	Cotswold DC, Trinity Rd Offices
drawing	Ground Floor West - Furniture Layout Opt1b
computer file	plot date
C:\Revit Projects\00373.000-AHR-TR-XX-M3-A-CENTRAL_stave.osullivan.rvt	
project number	scale
2021.00373.000	1 : 200 @A3
drawing number	rev issue status
CDC-AHR-ZW-00-DR-A-82-102b	P01 S2

This drawing is to be read in conjunction with all related drawings. All dimensions must be checked and verified on site before commencing any work or producing shop drawings. The originator should be notified immediately of any discrepancy. This drawing is copyright and remains the property of AHR.

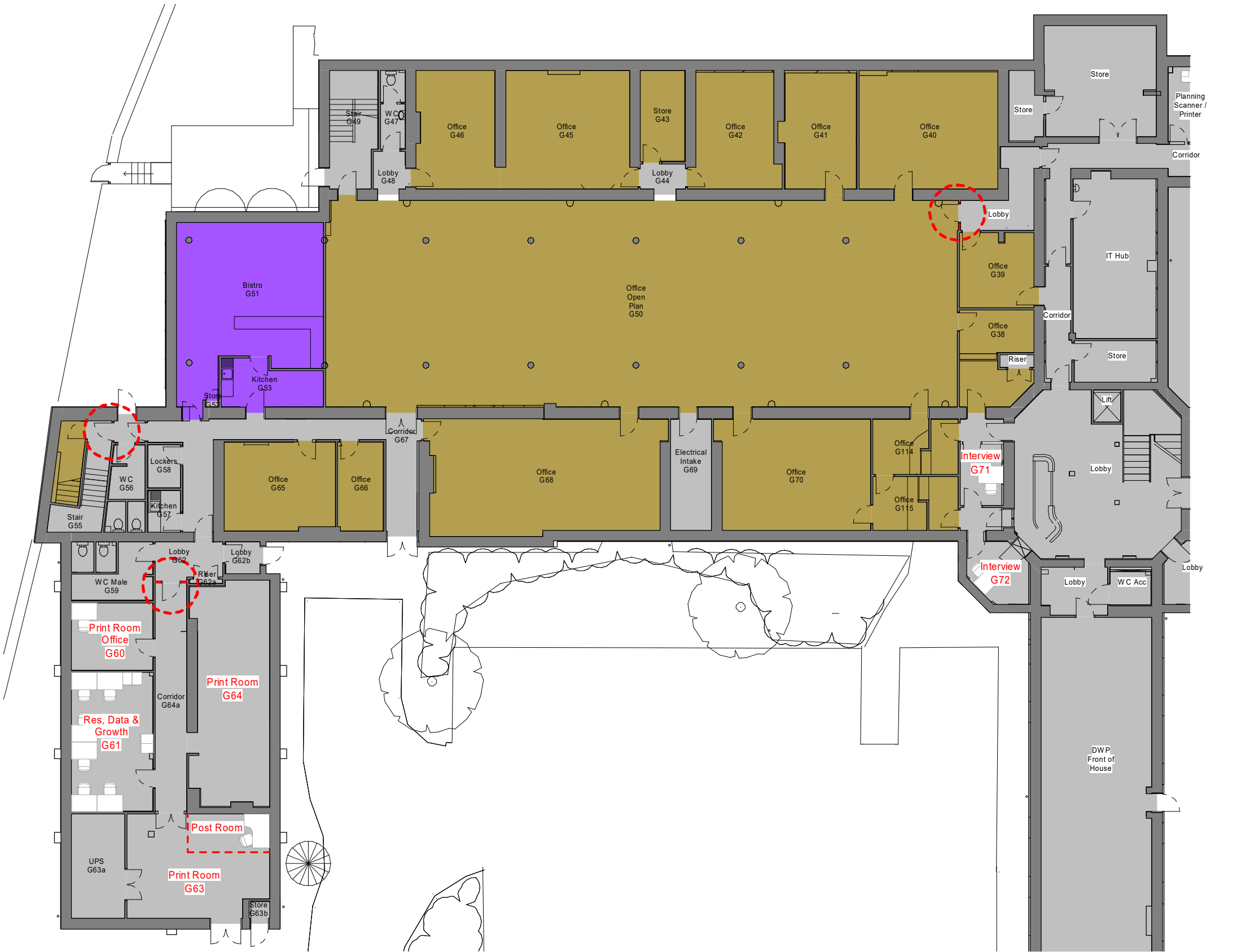

Level 0 - Furniture Layouts Opt1b - West

